

65  
MOTD

**FABRICWALL**

Stretch Systems for Walls & Ceilings

**INSIDE  
CORNER**

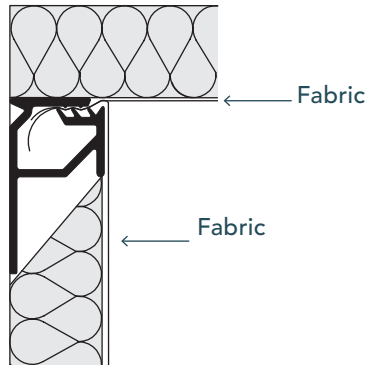

**CEILING**

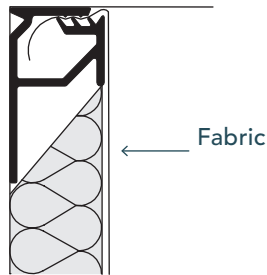

**BASE BOARD**

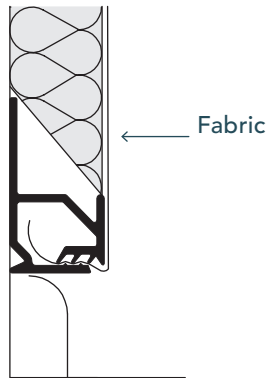

**DOOR JAMB**

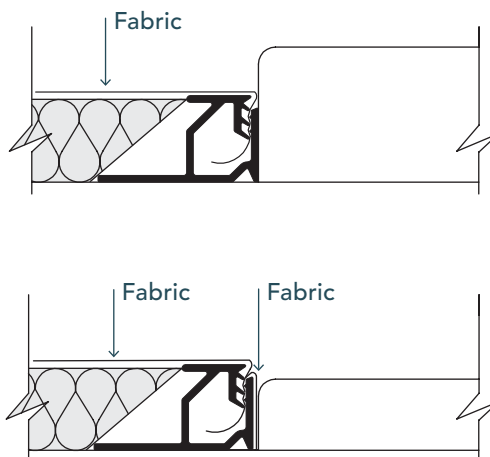

**DETAILS**

**DEPTH:** 5/8"

**LOAD:** Top Load.  
The fabric is tucked into the track from the top down.

**USAGE:** Perimeter track. Use at windows, doors, floors, corners and ceilings.

**EDGE:** Square

**EDGE WRAPPING:**  
Only required when the edge is exposed.